

D - Y - L - G

Diameter

Anchor Type

Length L

Grade

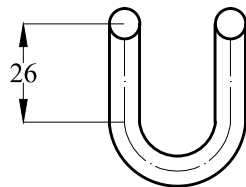
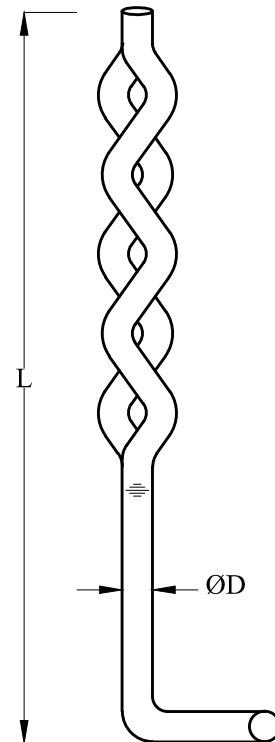
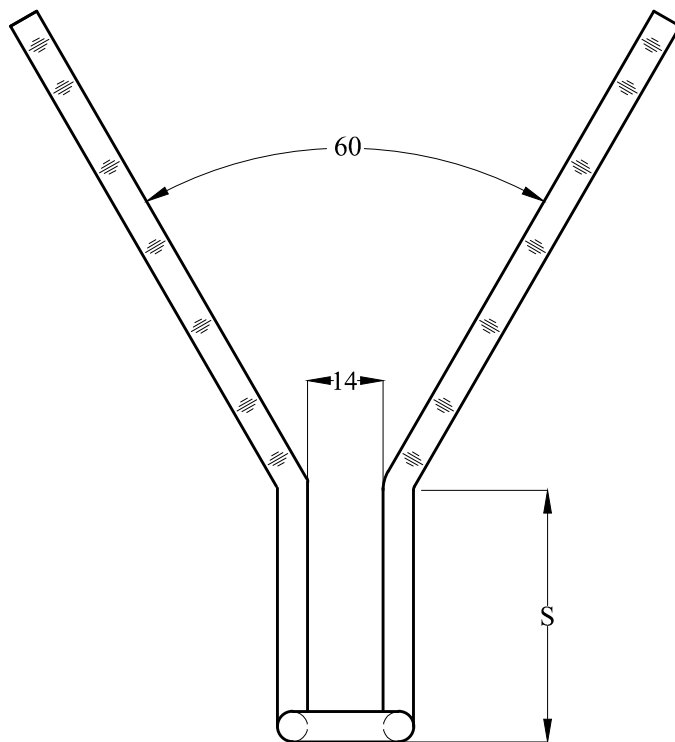

$$S = 1/3 L$$

Drowing Name: TW Movable Anchor		Volume (dm3) :		Sign				
Drowing Number: RSD-1025			Drown: Salmani		Revision	Sign	Description	Date
Made From: Stainless Steel 304, 309, 310S, 310			Checked: Almasizadeh					
Scale:1:2	Date:99/11/25		Approved: Khabbasi					



RAH SANAT Refractories Co